

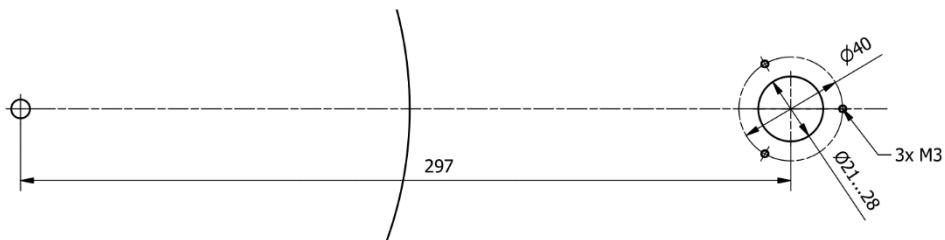

## EMT 912-HI Tonearm Datasheet

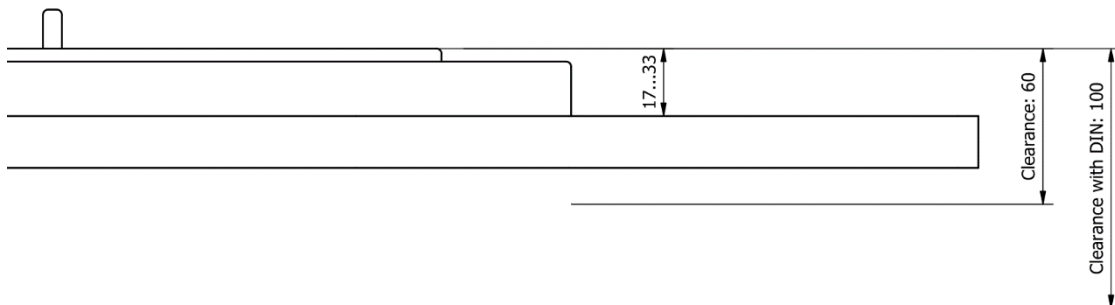

<b>Hi-end 12 inch tonearm</b>			
High-precision bearing technology with advanced tension compensating mechanism			
<b>Effective length:</b>	310.15mm	<b>Effective mass:</b>	11.4
<b>Offset angle:</b>	17.55°	<b>Overhang:</b>	13.15mm
<b>Outer null point:</b>	120.9mm	<b>Inner null point:</b>	66.04mm
<b>Connection:</b>	Hi-fi ½ inch	<b>Cartridge weight:</b>	8...25g
<b>Output:</b>	Wire outlet 20cm	<b>Option DIN:</b>	5-pin DIN outlet





## EMT 912 Tonearm Datasheet



Professional 12 inch tonearm for EMT Tondose			
High-precision bearing technology with advanced tension compensating mechanism			
<b>Effective length:</b>	310.15mm	<b>Effective mass:</b>	11.7
<b>Offset angle:</b>	17.55°	<b>Overhang:</b>	13.15mm
<b>Outer null point:</b>	120.9mm	<b>Inner null point:</b>	66.04mm
<b>Connection:</b>	EMT Tondose	<b>Option INT:</b>	Ortofon A compatible
<b>Output:</b>	Wire outlet 20cm	<b>Option DIN:</b>	5-pin DIN outlet

